

MIRABELLA AT MIRASOL PLAT "A"

A REPLAT OF A PORTION OF TRACTS AA AND BB, MIRASOL PLAT ONE, AS RECORDED IN PLAT BOOK 89, PAGES 14 THROUGH 23 OF THE PUBLIC RECORDS OF PALM BEACH COUNTY, FLORIDA, LYING IN SECTION 34, TOWNSHIP 41 SOUTH, RANGE 42 EAST, CITY OF PALM BEACH GARDENS, PALM BEACH COUNTY, FLORIDA

THIS INSTRUMENT PREPARED BY
DAVID P. LINDLEY
OF
CAULFIELD and WHEELER, INC.
SURVEYORS - ENGINEERS - PLANNERS
7301-A WEST PALMETTO PARK ROAD, SUITE 100A
BOCA RATON, FLORIDA 33433 - (561)392-1991
CERTIFICATE OF AUTHORIZATION NUMBER 3591
FEBRUARY - 2001
GRAPHIC SCALE

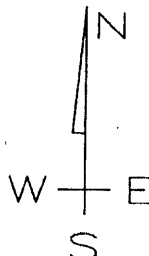
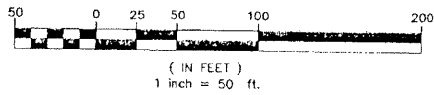

ABBREVIATION LEGEND

- P.P.M. - INDICATES 4" X 4" X 24" PERMANENT REFERENCE MONUMENT MARKED - PRM LB 3591
- DENOTES PERMANENT CONTROL POINT STAMPED - P.C.P LB#3591
- DENOTES CENTERLINE
- DE - INDICATES DRAINAGE EASEMENT
- FND - INDICATES FOUND
- I.E.E. - INDICATES INGRESS AND EGRESS EASEMENT
- MEAS - DENOTES MEASURED
- (NR) - INDICATES NON-RADIAL LINE
- N.T.S. - DENOTES NOT TO SCALE
- NO - DENOTES NUMBER
- NPBCD - DENOTES NORTHERN PALM BEACH COUNTY IMPROVEMENT DISTRICT
- ORB - DENOTES OFFICIAL RECORDS BOOK
- PAE - DENOTES PEDESTRIAN ACCESS EASEMENT
- PI - DENOTES PLAT BOOK
- POB - DENOTES POINT OF BEGINNING
- R/W - DENOTES RIGHT-OF-WAY
- S.E. - DENOTES SEWER LINE EASEMENT
- W.E. - DENOTES WATER LINE EASEMENT
- TWP - DENOTES TOWNSHIP
- UE - INDICATES UTILITY EASEMENT
- (PLAT) - DENOTES MIRASOL PLAT ONE, AS RECORDED IN PLAT BOOK 89, PAGES 14 THROUGH 23 OF THE PUBLIC RECORDS OF PALM BEACH COUNTY, FLORIDA
- ▶ DENOTES ZERO LOT LINE
- CT - DENOTES CURVE TABLE REFERENCE FOR CHORD BEARING AND DISTANCE
- WSE - WATER AND SEWER LINE EASEMENTS
- WWAC - WATER MANAGEMENT ACCESS EASEMENT
- WMME - WATER MANAGEMENT MAINTENANCE EASEMENT
- WME - WATER MANAGEMENT EASEMENT
- △ DENOTES CENTRAL ANGLE

CURVE	CHORD BEARING	DISTANCE
C1	S64°45'44"W	66.68
C2	S20°09'10"W	472.20
C3	S46°24'48"W	1053.41
C4	S18°08'50"W	117.58
C5	S20°04'10"W	199.17
C6	S47°17'04"E	290.65
C7	S40°39'54"E	523.73
C8	N00°44'12"E	56.38
C9	N09°38'42"W	88.35
C10	S07°25'25"E	119.10
C11	S49°54'36"W	352.15
C12	S23°31'29"W	190.43
C13	S68°17'49"W	190.42
C14	N83°39'45"W	78.83
C15	S83°39'45"E	78.83
C16	N85°01'39"E	78.83
C17	S85°01'39"W	78.83
C18	N44°09'51"W	283.60
C19	N66°44'39"W	153.56
C20	N21°35'09"W	153.58
C21	N45°50'09"E	282.08
C22	N12°51'42"E	82.30
C23	N57°42'35"E	217.70
C24	S65°04'10"W	172.92
C25	S77°07'12"E	82.19

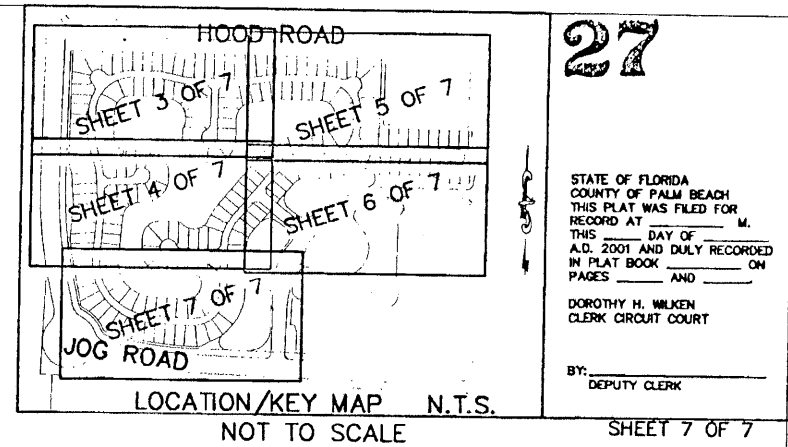

27

STATE OF FLORIDA
COUNTY OF PALM BEACH
THIS PLAT WAS FILED FOR
RECORD AT _____ M.
THIS _____ DAY OF
A.D. 2001 AND DULY RECORDED
IN PLAT BOOK _____ ON
PAGES _____ AND _____
DOROTHY H. WILKEN
CLERK CIRCUIT COURT
BY: _____
DEPUTY CLERK

